

This push-pull trim was designed for its easy operation to open hospital room doors for patients protection in case of fire. The wider handle integrated with a mortise lockcase provides wonderful versatility. The trim popularly used in hospitals and health care centers, now it can use in disabled restrooms, laboratories, operating rooms, and any other buildings where require more convenience, durability or security applications.

Features:

- The push-pull trim can be mounted in vertical (up or down) and horizontal orientations in field, see NOTE
- Through-bolted design for trims with lockcase in stability
- Handling is easily field reversible
- Fits for 1-3/4" (44mm) thick standard RHR or LHR hollow metal doors & wood doors, other than standard 1-3/4" (44mm) is available but specify door thickness when ordered.
- Push-Pull trim is non-handed, easy installation
- Mortise lock functions available (recommended): F01, F04, F05, F09, F11, F13, F14, F19, F20, F22, F30. Details see next page
- Handles are cast stainless steel, corrosion protected
- Patented in USA and UL listed
- Available in BHMA finishes

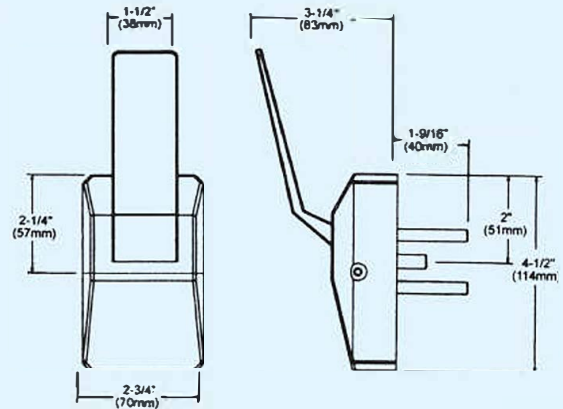

Note:

When cylinders are used, the handles MUST be mounted in down or horizontal positions on the cylinder side. The mounting way is the same required when thumbturn inside is used.

Designate hand and how handles are to be mounted that is PUSH down from inside of door, PULL up from outside of door

Multiple Mounting Hands:

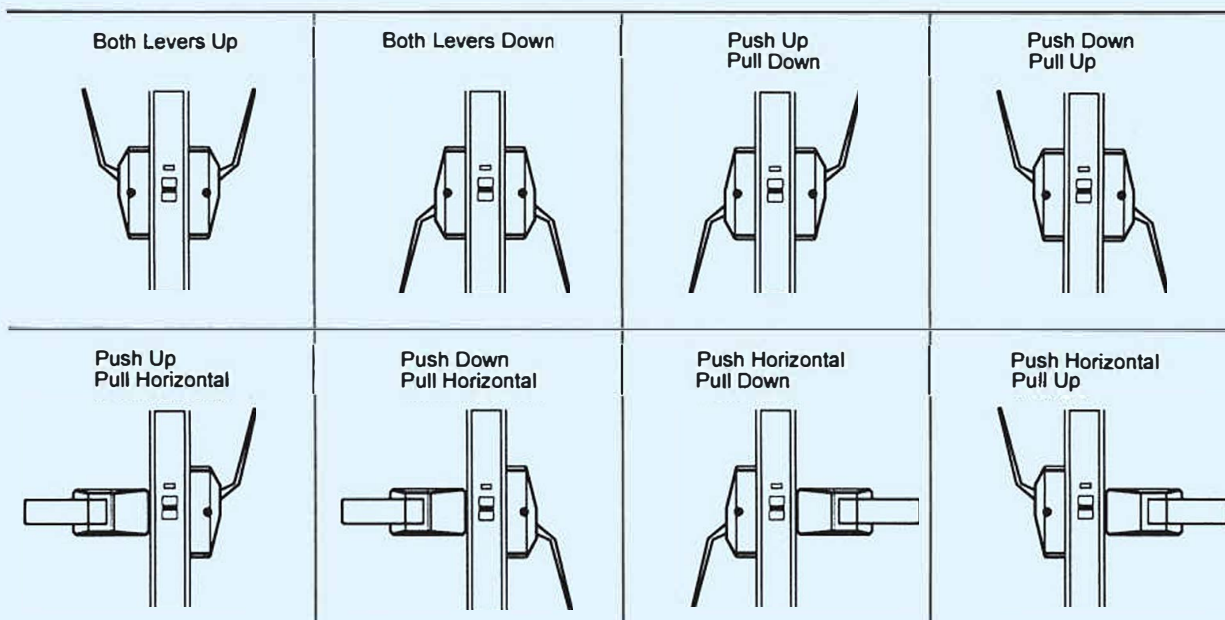

Model Number:

Our HL22 Push-Pull Trim can use with Schlage L Series Heavy Duty Mortise Locks, customers may just order HL22 Push-Pull Trim Only to use with Schlage mortise locks or to retrofit its existing installations. For other brand mortise locks such as Arrow, Best, Falcon, Sargent, Yale are also available, but need to consult our factory if customer has his requirement.

The model numbers of HL22 Push-Pull Trim with our M Series Heavy Duty Mortise Locks are listed below:

| ANSI No. | THASE Model Number | Function |
|----------|--------------------|--|
| F01 | M1001 - HL22 | Passage Latch |
| F04 | M3004 - HL22 | Office or Entry Lock |
| F05 | M2005 - HL22 | Classroom Lock |
| F09 | M2009 - HL22 | Apartment Entrance Lock, Public Toilet Lock |
| F11 | M3411 - HL22 | Dormitory or Exit Lock |
| F13 | M2413 - HL22 | Dormitory or Exit Lock |
| F14 | M2414 - HL22 | Store Door Lock |
| F19 | M2419 - HL22 | Privacy Bedroom, Bath Lock, |
| F20 | M3420 - HL22 | Apartment Corridor Door Lock |
| F22 | M1022 - HL22 | Privacy Bedroom, Bath Lock, |
| F30 | M2030 - HL22 | Asylum or Institution Lock |

Handle Handing:

Cylinder Operation:

Handle on cylinder side must be mounted in down or horizontal position, shown as below.

Thumbturn operation:

If a standard thumbturn (Type No. 132) is provided, the inside handle must be mounted in horizontal position. If a special thumbturn (Type No. 133) is provided, the inside handle can be mounted in down position. Specify the thumbturn type when ordering.

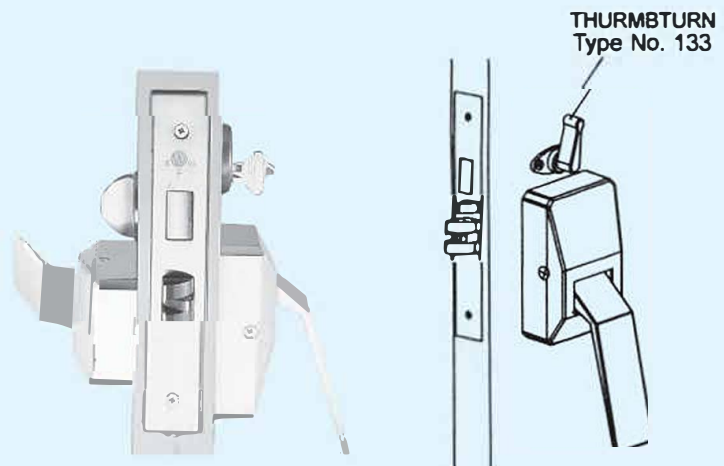

This Push-Pull Trim with heavy-duty mortise lock is model number M2413-HL22 (ANSI function no. 13) Dormitory or Exit Lock shown, which uses a standard thumbturn Type No. 132 and along with an inside wider handle in horizontal position.